

Study places

- Group study places 06 - 01 BSc - **B.0**
- Group study places 09 - 14 BSc - **B.0**
- Group study places 15 - 25 BSc - **C.0**
- Group study places 42 - 32 BSc - **E.0**
- Group study places 43 - 50 BSc - **C.1**
- Group study places 51 - 58 BSc - **E.1**
- Study places - **A.0**
- 60 MSc study places and PhD places - **B.k1**
- 12 MSc study places - **E.3**
- P-room & graduation places - **B.3**
- PC-room 72 PC's - **C.1**
- P-room - **C.1**
- Design Studio ME - **G.0**
- Graduation places - **F.2**
- Mechatronics Project room - **G.0**
- Design Studios MT - **B.0**
- Design Studios 6-11 / 12-16 / 17-19 / 20-22 ID - **C.1 / D.1 / A.1**
- Flex self study area ID - **A.0**
- Graduation workspaces ID - **B.0**
- Zebra computer rooms ID - **B.0**
- Self study area ID - **C.k1**
- Drawing rooms ID - **D.1**
- Studyplaces - [Leeghwaterstr. 44 1st floor](#)

Facilities

- Service point 3mE - **A.0**
- Coffee corner - **A.0**
- M. r. Warner Koiter 15 pers / beamer available - **A.1**
- M. r. Johannes Burgers 10 pers / beamer available - **A.1**
- M.r. Cor Biezeno 12 pers / beamer available - **A.1**
- Delft Center for Entrepreneurship - **B.4**
- Documentation Center MT - **D.1**
- Documentation Center ME - **G.1**
- First aid 3mE - **G.1**
- Sport area - **J.k1**
- Facultyroom & 't Lagerhuysch - **A.0**
- Examination building - **next L**
- PMB shop repository ID - **D.k1**
- 3mE / ID Restaurant - **A.0**
- Service point ID - **A.0**
- First aid ID - **C.0**
- Waltman ID - **A.0**
- Flex Delft ID - **A.0**
- Material library ID - **A.0**
- First aid P&E - [Leeghwaterstr. 44 gf](#)

Lecture rooms

- A** Leonardo da Vinci - **A.0**
- B** Isaac Newton - **A.0**
- C** Daniel Bernoulli - **A.0**
- D** James Watt - **A.0**
- E** Robert Hooke - **A.0**
- F** Simon Stevin - **A.0**
- J** Coenraad Stork - **B.3**
- L** Huub van Doorne - **B.2**
- R** Emile Truijen - **A.0**
- S** Bernd Schierbeek - **D.1**
- T** Joost van der Grinten ID - **A.0**
- U** Wim Crouwel ID - **A.1**
- V** Hans Dirken ID - **C.3**
- Rudolf Diesel - [Leeghwaterstr. 44 1st floor](#)

Services

- Education & Student Affairs (E&SA) - **E.0**
- TUD University Board - **H.0**
- FS= Faculty Secretariat - **A.1**
- HR= Human Resources - **A.1**
- F&C= Finance & Control - **A.1**
- M&C= Marketing & Communication - **A.1**
- FMVG= Facility Management & Real Estate ID - **C.k1**
- ARBO - **A.1**
- Leeghwater - **E.0**
- Froude - **B.0**
- Study Association i.d. - **B.0**
- Education & Student Affairs ID (E&SA) - **C.4**
- PIM= Product Innovation Management ID - **B.4**
- P&E support - [Leeghwaterstr. 44 1st floor](#)

laboratories

- DPTI= Delft Process Technology Institute - **K.0**
- MSP= Multi-Scale Physics - **K.0**
- MSE Lab - **J.0**
- Assembly workshop - **J.k1**
- Meetshop - **G.0**
- Inloopwerkplaats Mechanische Bew. - **G.0**
- Logistics Lab - **G.0**
- DCSC Robotics Lab - **F.0**
- PME Lab - **F.0**
- DCSC Lab - **F.0**
- P&E Aero & Hydro Lab - **F.0**
- Delft Haptics Lab - **F.1**
- MT-Towing tank - **D.0**
- Delft Biorobotics Lab - **E.0**
- PMP= Workshop for Prototypes and Tooling ID - **C.0**
- ID-users Lab - **C.2**
- ID-studio Lab - **B.2**
- Product Evaluation Lab ID - **B.4**
- P&E Lab/Thermolab/ETH Lab/Analytical Lab - [Leeghwaterstr. 44 gf](#)

Departments

- P&E= Procs & Energy - **F.0 / J.0 / Leeghwaterstr. 44**
- MSE= Materials Science & Engineering - **J.0 / H.1 / H.2 / H.3 / H.4**
- Materials Science & Engineering (Biomaterials) - **J.0**
- PME= Precision Microsystems and Engineering - **G.1 / F.0**
- DCSC= Delft Center for Systems and Control - **F.0 / E.2 / E.3 / E.4**
- BmechE= Biomechanical Engineering - **E.0 / E.1**
- M&TT= Marine & Transport Technology - **D.0 / D.1 / B.1**
- DE= Design Engineering - **B.3**
- ID= Industrial Design - **A.0 / A.3**

Levels

- (k1) Cellar
- (0) Ground floor
- (1) First floor
- (2) Second floor
- (3) Third floor
- (4) Fourth floor

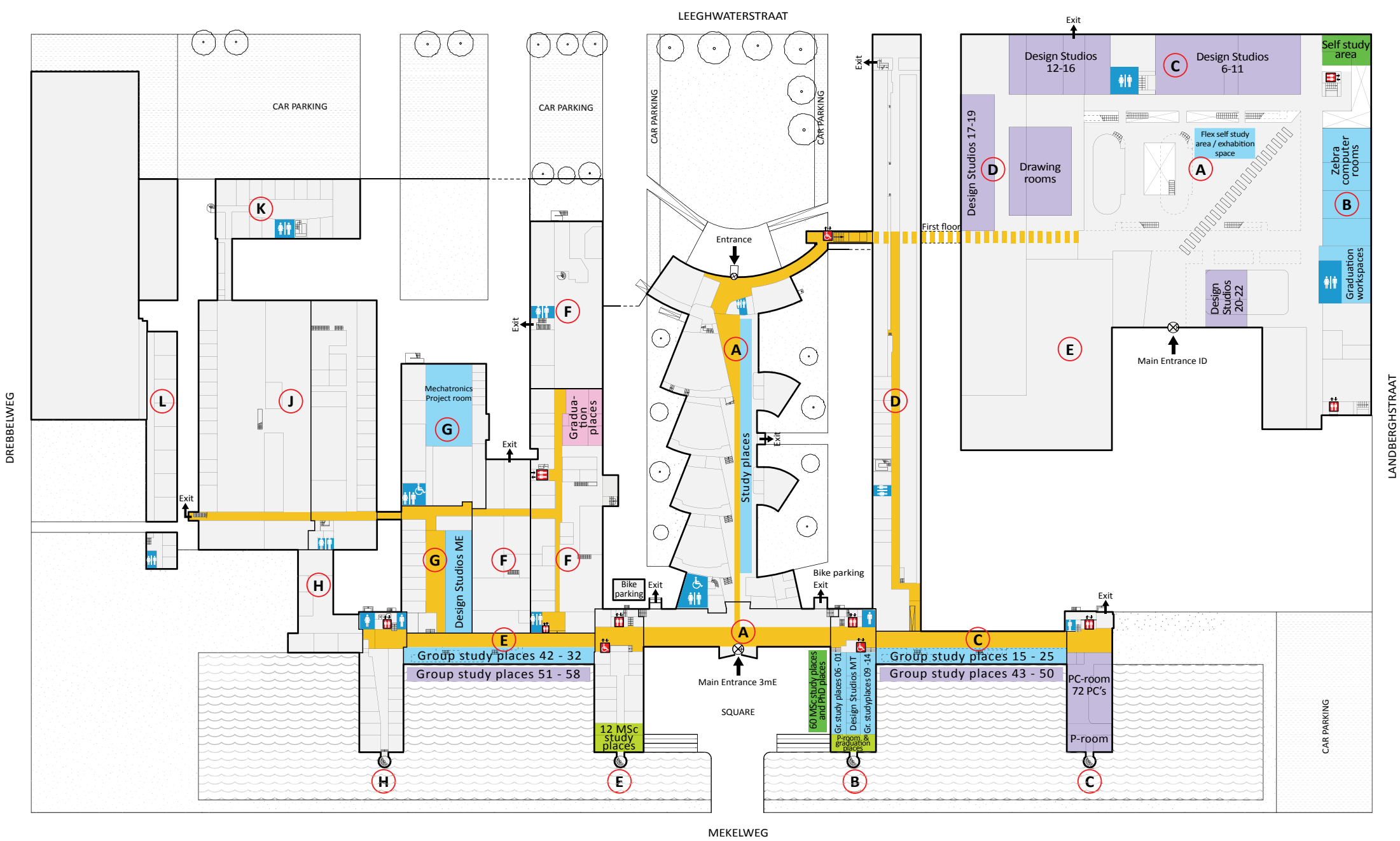

Study places

- Group study places 06 - 01 BSc - **B.0**
- Group study places 09 - 14 BSc - **B.0**
- Group study places 15 - 25 BSc - **C.0**
- Group study places 42 - 32 BSc - **E.0**
- Group study places 43 - 50 BSc - **C.1**
- Group study places 51 - 58 BSc - **E.1**
- Study places - **A.0**
- 60 MSc study places and PhD places - **B.k1**
- 12 MSc study places - **E.3**
- P-room & graduation places - **B.3**
- PC-room 72 PC's - **C.1**
- P-room - **C.1**
- Design Studio ME - **G.0**
- Graduation places - **F.2**
- Mechatronics Project room - **G.0**
- Design Studios MT - **B.0**
- Design Studios 6-11 / 12-16 / 17-19 / 20-22 ID - **C.1 / D.1 / A.1**
- Flex self study area ID - **A.0**
- Graduation workspaces ID - **B.0**
- Zebra computer rooms ID - **B.0**
- Self study area ID - **C.k1**
- Drawing rooms ID - **D.1**
- Studyplaces - [Leeghwaterstr. 44 1st floor](#)

Facilities

Lecture rooms

Services

laboratories

Departments

Levels

- (k1) Cellar
- (0) Ground floor
- (1) First floor
- (2) Second floor
- (3) Third floor
- (4) Fourth floor

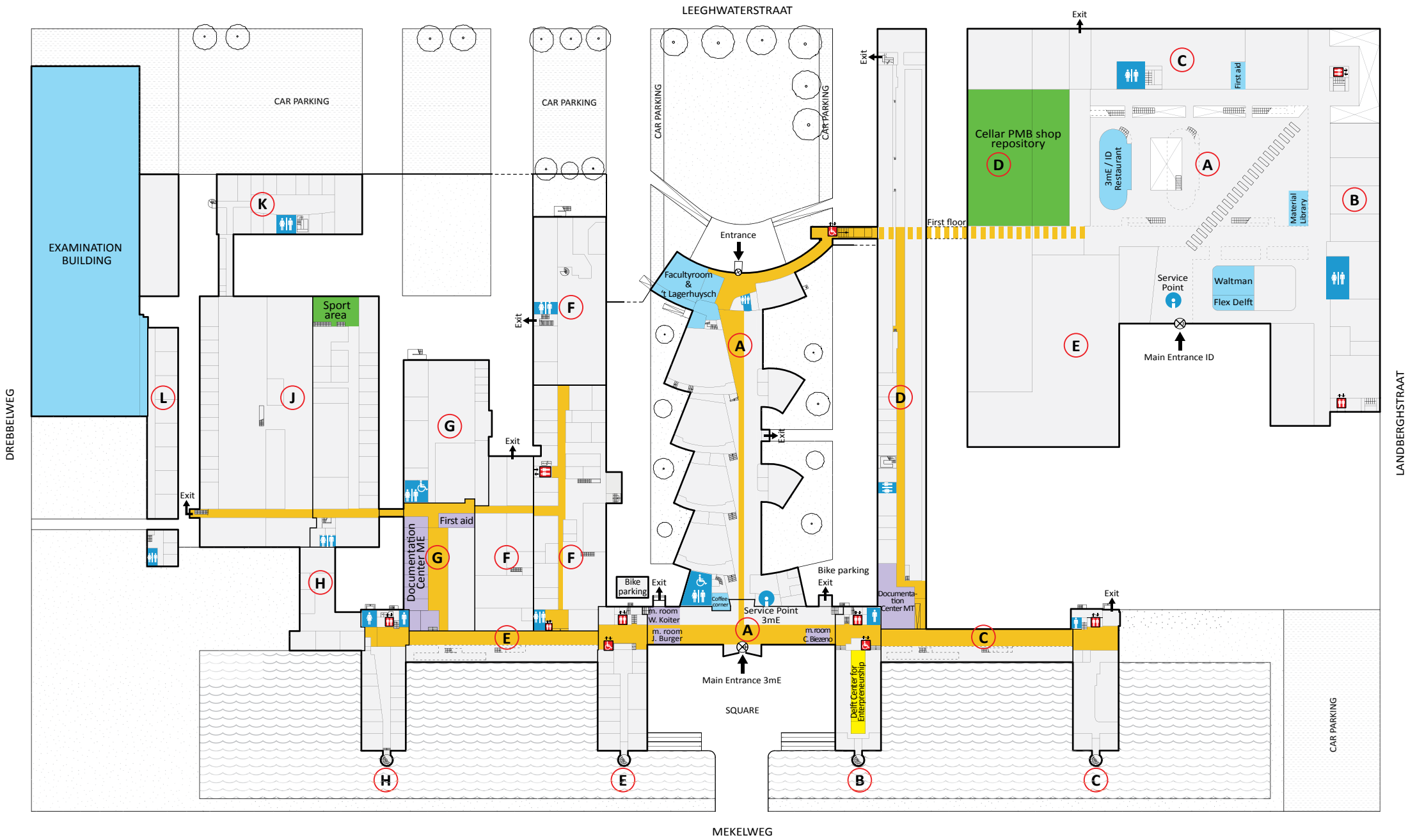

Study places

Facilities

Lecture rooms

Services

laboratories

Departments

Levels

- Service point 3mE - **A.0**
- Coffee corner - **A.0**
- M. r. Warner Koiter 15 pers / beamer available - **A.1**
- M. r. Johannes Burgers 10 pers / beamer available - **A.1**
- M.r. Cor Biezeno 12 pers / beamer available - **A.1**
- Delft Center for Enterpreneurship - **B.4**
- Documentation Center MT - **D.1**
- Documentation Center ME - **G.1**
- First aid 3mE - **G.1**
- Sport area - **J.k1**
- Facultyroom & 't Lagerhuysch - **A.0**
- Examination building - **next L**
- PMB shop repository ID - **D.k1**
- 3mE / ID Restaurant - **A.0**
- Service point ID - **A.0**
- First aid ID - **C.0**
- Waltman ID - **A.0**
- Flex Delft ID - **A.0**
- Material library ID - **A.0**
- First aid P&E - [Leeghwaterstr. 44 gf](#)

- (k1) Cellar
- (0) Ground floor
- (1) First floor
- (2) Second floor
- (3) Third floor
- (4) Fourth floor

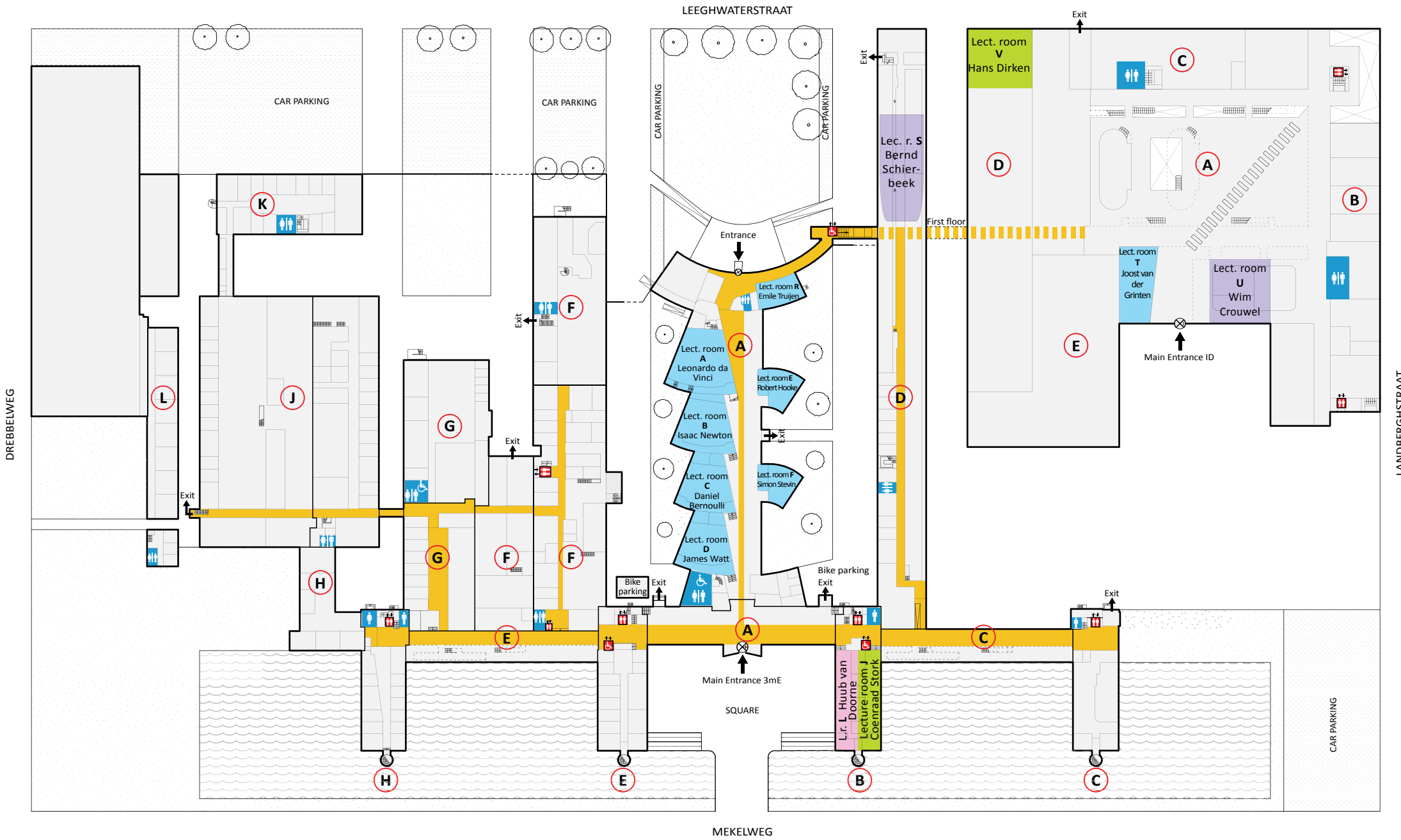

Study places

Facilities

Lecture rooms

Services

laboratories

Departments

Levels

- A Leonardo da Vinci - A.0
- B Isaac Newton - A.0
- C Daniel Bernoulli - A.0
- D James Watt - A.0
- E Robert Hooke - A.0
- F Simon Stevin - A.0
- J Coenraad Stork - B.3
- L Huub van Doorne - B.2
- R Emile Truijen - A.0
- S Bernd Schierbeek - D.1
- T Joost van der Grinten ID - A.0
- U Wim Crouwel ID - A.1
- V Hans Dirken ID - C.3
- Rudolf Diesel - [Leeghwaterstr. 44](#)

[1st floor](#)

- (k1) Cellar
- (0) Ground floor
- (1) First floor
- (2) Second floor
- (3) Third floor
- (4) Fourth floor

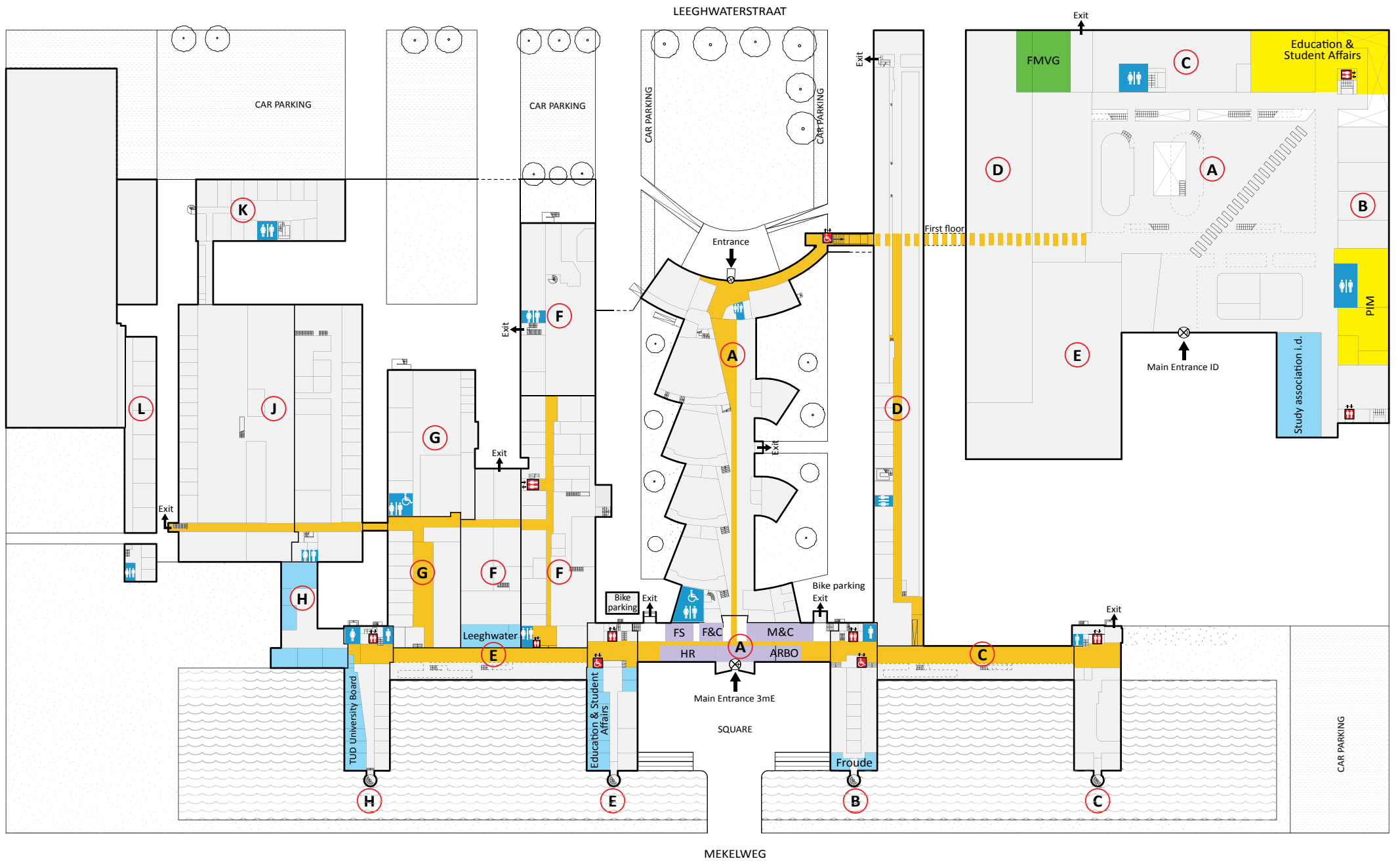

MEKELWEG



Study places

Facilities

Lecture rooms

Services

laboratories

Departments

Levels

- Education & Student Affairs (E&SA) - E.0
- TUD University Board - H.0
- FS= Faculty Secretariat - A.1
- HR= Human Resources - A.1
- F&C= Finance & Control - A.1
- M&C= Marketing & Communication - A.1
- FMVG= Facility Management & Real Estate ID - C.k1
- ARBO - A.1
- Leeghwater - E.0
- Froude - B.0
- Study Association i.d. - B.0
- Education & Student Affairs ID (E&SA) - C.4
- PIM= Product Innovation Management ID - B.4
- P&E support - [Leeghwaterstr. 44 1st floor](#)

- (k1) Cellar
- (0) Ground floor
- (1) First floor
- (2) Second floor
- (3) Third floor
- (4) Fourth floor

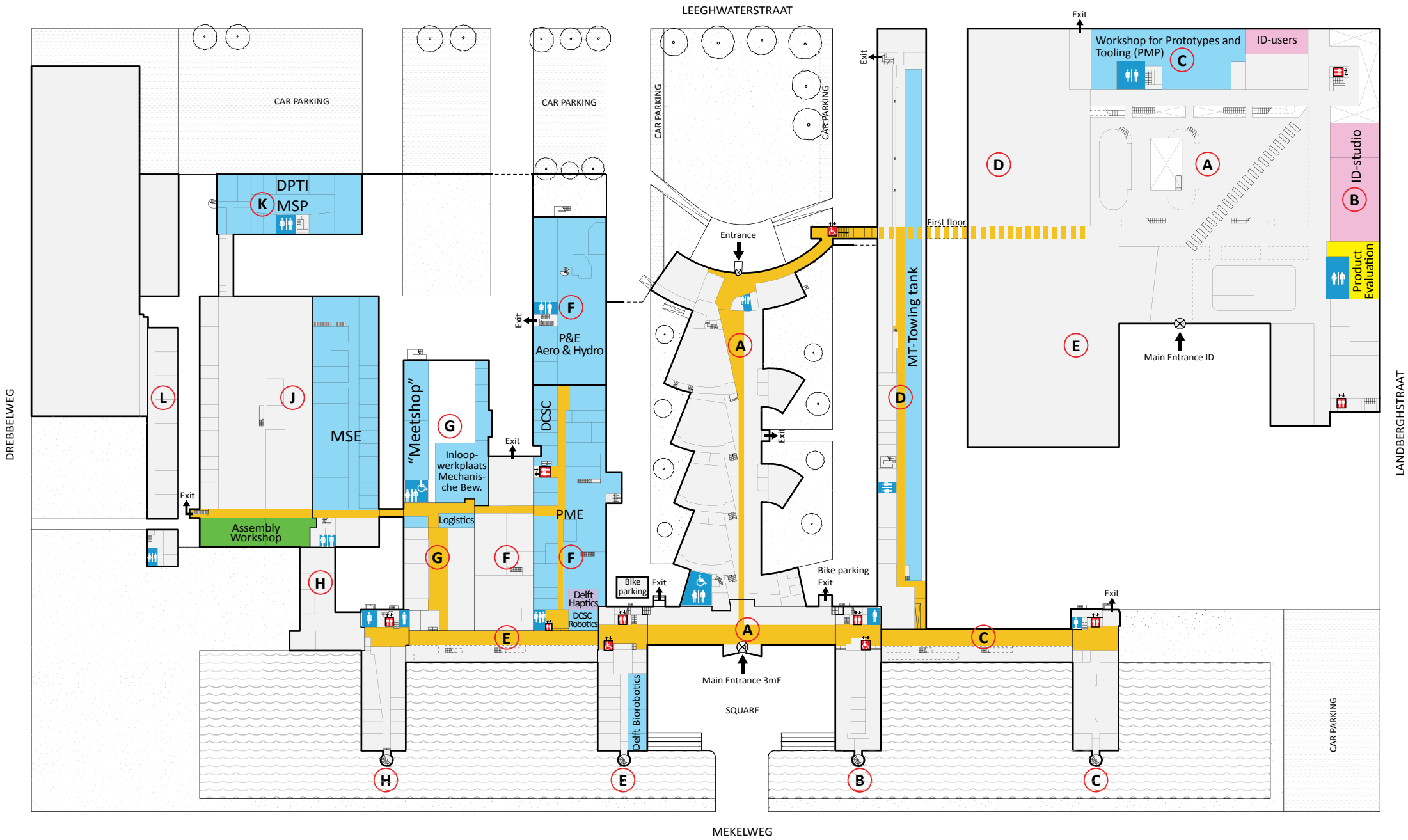

Study places

Facilities

Lecture rooms

Services

laboratories

Departments

Levels

- DPTI= Delft Process Technology Institute - **K.0**
- MSP= Multi-Scale Physics - **K.0**
- MSE Lab - **J.0**
- Assembly workshop - **J.k1**
- Meetshop - **G.0**
- Inloopwerkplaats Mechanische Bew. - **G.0**
- Logistics Lab - **G.0**
- DCSC Robotics Lab - **F.0**
- PME Lab - **F.0**
- DCSC Lab - **F.0**
- P&E Aero & Hydro Lab - **F.0**
- Delft Haptics Lab - **F.1**
- MT-Towing tank - **D.0**
- Delft Biorobotics Lab - **E.0**
- PMP= Workshop for Prototypes and Tooling ID - **C.0**
- ID-users Lab - **C.2**
- ID-studio Lab - **B.2**
- Product Evaluation Lab ID - **B.4**
- P&E Lab/Thermolab/ETH Lab/Analytical Lab - [Leeghwaterstr. 44 gf](#)

- (k1) Cellar
- (0) Ground floor
- (1) First floor
- (2) Second floor
- (3) Third floor
- (4) Fourth floor

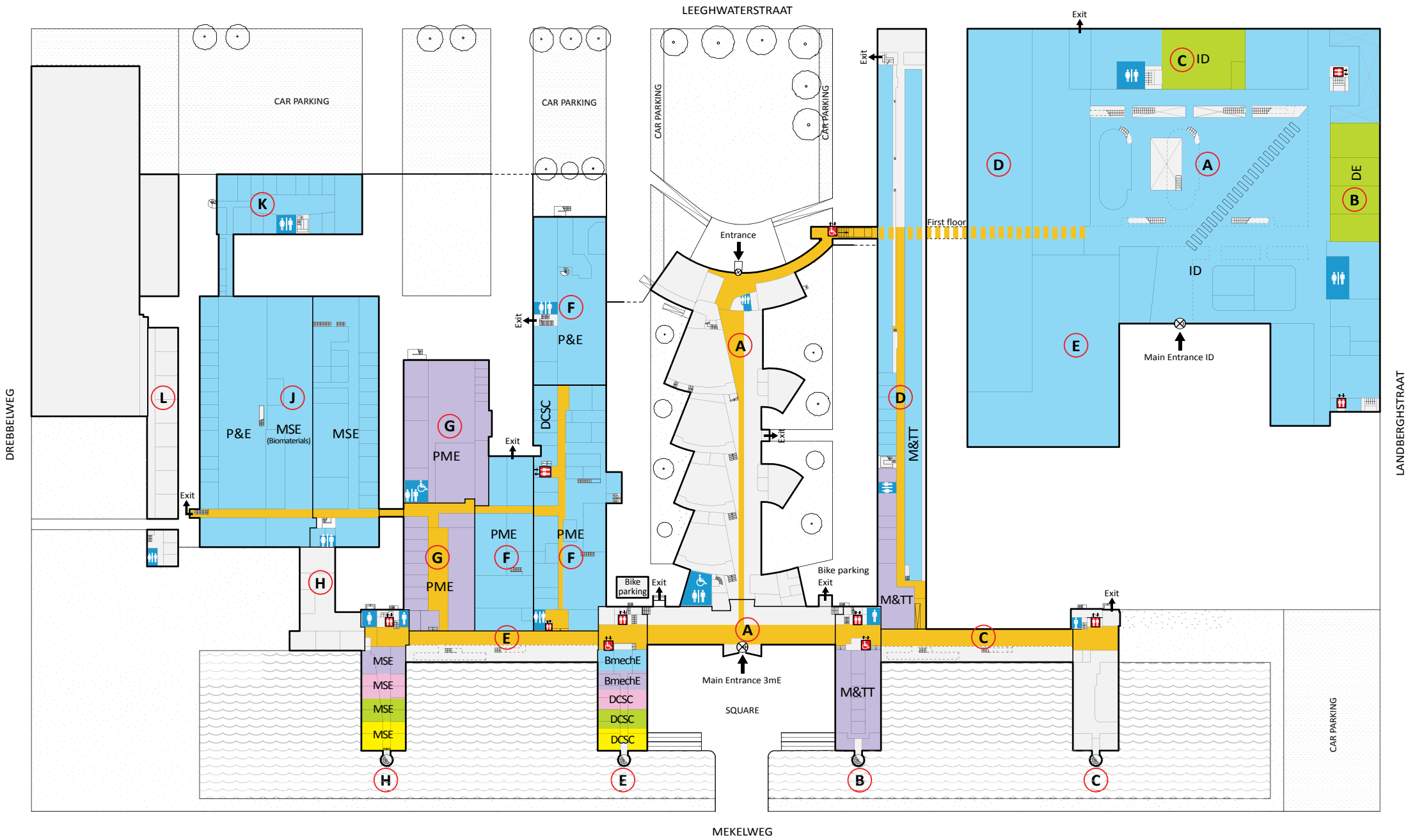

Study places

Facilities

Lecture rooms

Services

laboratories

Departments

Levels

- P&E= Proces & Energy - F.0 / J.0 / Leeghwaterstr. 44
- MSE= Materials Science & Engineering - J.0 / H.1 / H.2 / H.3 / H.4
- Materials Science & Engineering (Biomaterials) - J.0
- PME= Precision Microsystems and Engineering - G.1 / F.0
- DCSC= Delft Center for Systems and Control - F.0 / E.2 / E.3 / E.4
- BmechE= Biomechanical Engineering - E.0 / E.1
- M&TT= Marine & Transport Technology - D.0 / D.1 / B.1
- DE= Design Engineering - B.3
- ID= Industrial Design - A.0 / A.3

- (k1) Cellar
- (0) Ground floor
- (1) First floor
- (2) Second floor
- (3) Third floor
- (4) Fourth floor

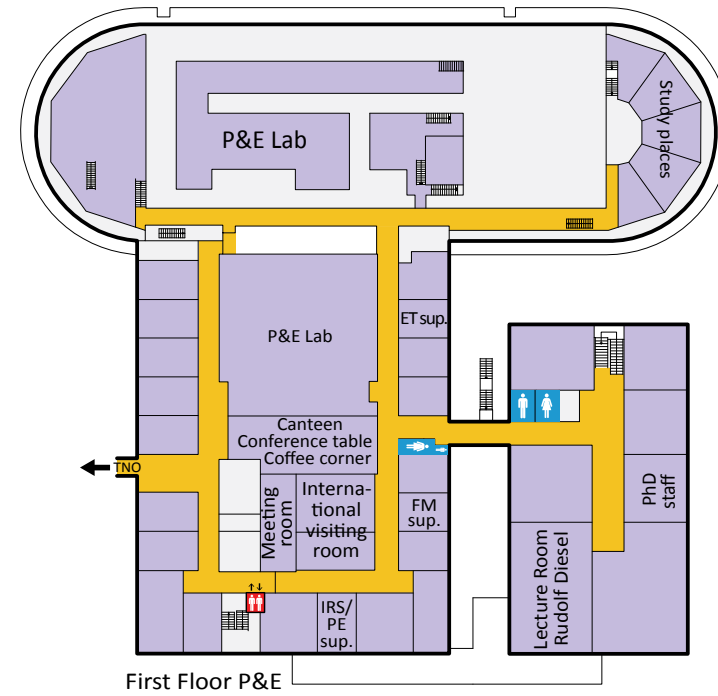
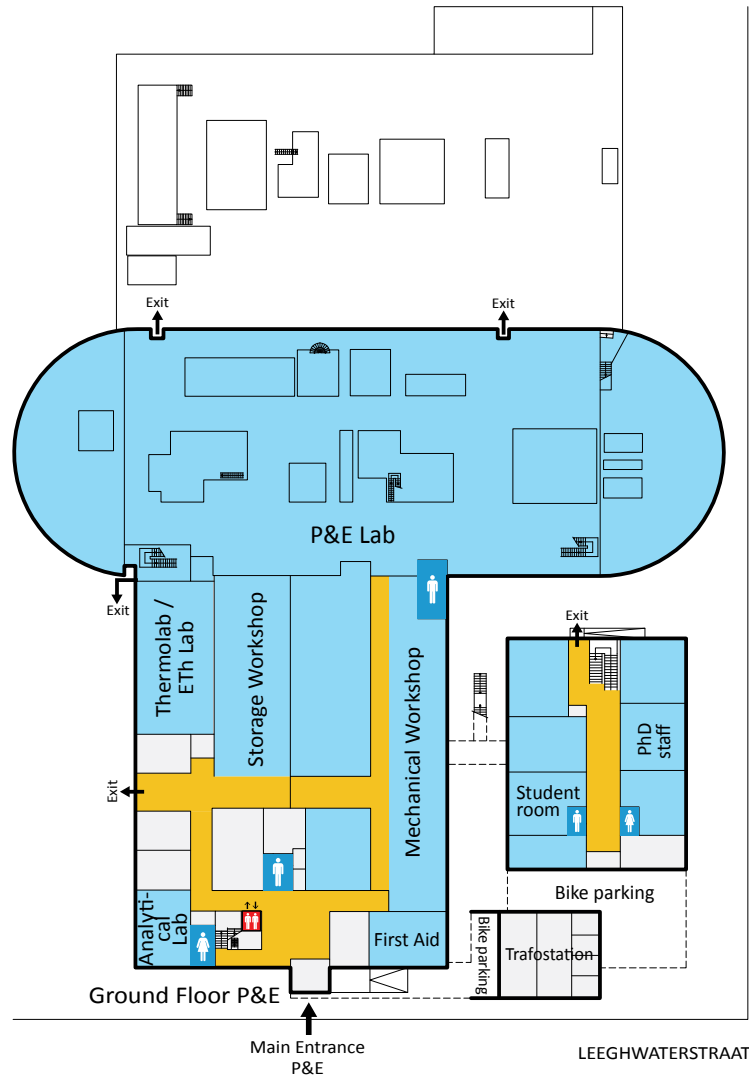
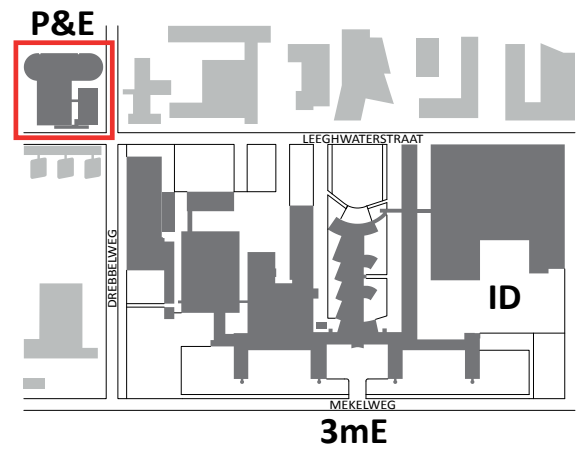

Study places

Group study places 06 - 01 BSc - **B.0**
 Group study places 09 - 14 BSc - **B.0**
 Group study places 15 - 25 BSc - **C.0**
 Group study places 42 - 32 BSc - **E.0**
 Group study places 43 - 50 BSc - **C.1**
 Group study places 51 - 58 BSc - **E.1**
 Study places - **A.0**
 60 MSc study places and PhD places - **B.k1**
 12 MSc study places - **E.3**
 P-room & graduation places - **B.3**
 PC-room 72 PC's - **C.1**
 P-room - **C.1**
 Design Studio ME - **G.0**
 Graduation places - **F.2**
 Mechatronics Project room - **G.0**
 Design Studios MT - **B.0**
 Design Studios 6-11 / 12-16 / 17-19 / 20-22 ID - **C.1 / D.1 / A.1**
 Flex self study area ID - **A.0**
 Graduation workspaces ID - **B.0**
 Zebra computer rooms ID - **B.0**
 Self study area ID - **C.k1**
 Drawing rooms ID - **D.1**
 Studyplaces - **Leeghwaterstr. 44 1st floor**

Facilities

Service point 3mE - **A.0**
 Coffee corner - **A.0**
 M. r. Warner Koiter 15 pers / beamer available - **A.1**
 M. r. Johannes Burgers 10 pers / beamer available - **A.1**
 M.r. Cor Biezeno 12 pers / beamer available - **A.1**
 Delft Center for Entrepreneurship - **B.4**
 Documentation Center MT - **D.1**
 Documentation Center ME - **G.1**
 First aid 3mE - **G.1**
 Sport area - **J.k1**
 Facultyroom & 't Lagerhuysch - **A.0**
 Examination building - **next L**
 PMB shop repository ID - **D.k1**
 3mE / ID Restaurant - **A.0**
 Service point ID - **A.0**
 First aid ID - **C.0**
 Waltman ID - **A.0**
 Flex Delft ID - **A.0**
 Material library ID - **A.0**
 First aid P&E - **Leeghwaterstr. 44 gf**

Lecture rooms

A Leonardo da Vinci - **A.0**
B Isaac Newton - **A.0**
C Daniel Bernoulli - **A.0**
D James Watt - **A.0**
E Robert Hooke - **A.0**
F Simon Stevin - **A.0**
J Coenraad Stork - **B.3**
L Huub van Doorne - **B.2**
R Emile Truijen - **A.0**
S Bernd Schierbeek - **D.1**
T Joost van der Grinten ID - **A.0**
U Wim Crouwel ID - **A.1**
V Hans Dirken ID - **C.3**
 Rudolf Diesel - **Leeghwaterstr. 44 1st floor**

Services

Education & Student Affairs (E&SA) - **E.0**
 TUD University Board - **H.0**
 FS= Faculty Secretariat - **A.1**
 HR= Human Resources - **A.1**
 F&C= Finance & Control - **A.1**
 M&C= Marketing & Communication - **A.1**
 FMVG= Facility Management & Real Estate ID - **C.k1**
 ARBO - **A.1**
 Leeghwater - **E.0**
 Froude - **B.0**
 Study Association i.d. - **B.0**
 Education & Student Affairs ID (E&SA) - **C.4**
 PIM= Product Innovation Management ID - **B.4**
 P&E support - **Leeghwaterstr. 44 1st floor**

laboratories

DPTI= Delft Process Technology Institute - **K.0**
 MSP= Multi-Scale Physics - **K.0**
 MSE Lab - **J.0**
 Assembly workshop - **J.k1**
 Meetshop - **G.0**
 Inloopwerkplaats Mechanische Bew. - **G.0**
 Logistics Lab - **G.0**
 DCSC Robotics Lab - **F.0**
 PME Lab - **F.0**
 DCSC Lab - **F.0**
 P&E Aero & Hydro Lab - **F.0**
 Delft Haptics Lab - **F.1**
 MT-Towing tank - **D.0**
 Delft Biorobotics Lab - **E.0**
 PMP= Workshop for Prototypes and Tooling ID - **C.0**
 ID-users Lab - **C.2**
 ID-studio Lab - **B.2**
 Product Evaluation Lab ID - **B.4**
 P&E Lab/Thermolab/ETH Lab/Analytical Lab - **Leeghwaterstr. 44 gf**

Departments

P&E= Proces & Energy - **F.0 / J.0 / Leeghwaterstr. 44**
 MSE= Materials Science & Engineering - **J.0 / H.1 / H.2 / H.3 / H.4**
 Materials Science & Engineering (Biomaterials) - **J.0**
 PME= Precision Microsystems and Engineering - **G.1 / F.0**
 DCSC= Delft Center for Systems and Control - **F.0 / E.2 / E.3 / E.4**
 BmechE= Biomechanical Engineering - **E.0 / E.1**
 M&TT= Marine & Transport Technology - **D.0 / D.1 / B.1**
 DE= Design Engineering - **B.3**
 ID= Industrial Design - **A.0 / A.3**

Levels

(k1) Cellar
 (0) Ground floor
 (1) First floor
 (2) Second floor
 (3) Third floor
 (4) Fourth floor